

Tie Rod End Remover And Installer



AC78-1091

- To remove fast and easily worn tie rods and install new tie rods with a 27mm spanner or 1/2" DR.
- It for mainly for European passenger cars
- Head application: $\varnothing 35-45\text{mm}$
- Head OD: $\varnothing 89\text{mm}$
- Hollow body length: 400mmL

Tie Rod End Remover And Installer



AC78-1091B

- To remove fast and easily worn tie rods and install new tie rods with a 27mm spanner or 1/2" DR.
- It for European and Japanese small cars (below 2000cc)
- Head application: $\varnothing 28-35\text{mm}$
- Head OD: $\varnothing 72\text{mm}$
- Hollow body length: 400mmL

4pcs Wheel Internal Thread Kit



AC08-590504

- For use on vehicles that use wheel bolts
- M12x1.25 For PSA
- M12x1.5 For Mercedes Benz and BMW
- M12x1.75 For Volvo
- M14x1.5 For VAG models

13pcs Wheel Stud Installer / Wheel Internal Thread Tools



AC08-590512

- Self-centering to insure that the stud is installed at the correct angle.
- Kits include a bearing seat and nut
- Will not damage wheel stud threads Automotive kit.
- Sizes: 7/16"x20 UNF, 1/2"-20 UNF, M12x1.25, M12x1.50 and M12x1.75 and M14x1.5
- Sizes: M12x1.25mm, M12x1.5mm, M12x1.75mm, M14x1.5mm
- Application: Mercedes-Benz Models

Dual Mass Flywheel-Special Tool (DMF)



AC08-853524

- Many vehicle manufacturers choose to equip new models with a Dual Mass Flywheel and the trend is growing. The reasons for this are the technical benefits provided by the DMF as well as the need for increasing noise comfort while reducing emissions of state-of-the-art engines. The DMF characteristics are precisely attuned to each vehicle.
- Always check the Dual Mass Flywheel (DMF) when replacing the clutch. A worn and defective DMF can damage the newly installed clutch!
- A 100% functional test of the Dual Mass Flywheel includes among other things testing the characteristics of the Arc Springs during compression. This testing can only be carried out using a special test facility.
- In addition, your assessment of the DMF's operational reliability should be based on the following criteria: grease egress condition of the friction surface (e.g. signs of thermal load / thermal cracks) noise emissions condition of the clutch, etc. mileage
- When uncertain, always replace the DMF along with the clutch.

Inner Bearing Ring Extraction



AC08-905515

- Allows precise extraction of inner bearing race from the wheel hub.
- Removal of the hub almost always leaves the inner race on the hub. The race is impossible to remove without the correct special tool.
- Makeshift methods such as grinders, Chisels, Welding torches, etc. represent severe risks of personal injury or damage to the components.
- The new puller set allow quick and easy removal of inner bearing races with diameters from 40mm to 72mm with a few minutes without risk of damage or injury.
- VW-Audi, BMW, Ford, Fiat, Mercedes-Benz, Opel, Renault, Peugeot, Volvo etc.

Universal Spring Compressor



AC06-6358A

- For replacement of self-leveling shock absorbers
- Particularly for rear axles on Mercedes & Fords
- Compression length: 85-170 mm

Pipe Stretcher Kit



AC08-850507

- Expands all types of exhaust pipe, including stainless steel, from 1-5/8 inches to 4-1/4 inches in size
- Inexpensive alternative to hydraulic pipe expanders

Pulling Device For Silentbloccs



AC08-589522

- Suitable for Mercedes E-Class(W211) rear axle sub-frame

Flywheel Locking Tool (Universal)



AC82-BT030

- Necessary for dismantling or re-assembling flywheels, clutch pressure plates and belt pulley
- Length: 250mm

Wheel Hub Puller Set



AC08-590531

- Puller plate size: A:90-130mm, B:100-180mm
- Puller bolts: M12x1.25, M12x1.5, M12x1.75, M14x1.5, M16x1.5
- Hex nut: M14x1.5
- Adaptor: 2-1/4"x14UNS on M18x1.5
- Slide Hammer: 4.8kg
- Spindle: M18x1.5 x 230mm
- Suitable for Alfa Romeo, Audi, BMW, Citroen, Fiat, Ford, Opel, Mercedes-Benz, Skoda, Seat, Volkswagen, Mazda, Porsche, Renault, etc.

Rear Brush Installation Tool



AC06-6390

- For the removal and installation of the rear bushes on Ford Fiesta and Ka from 1996 onwards without removing the suspension trailing link

Rear Brush Installation Tool



AC06-6380

- Suitable for in-situ installation of rear axle mounting bushes on selected VW & Audi vehicles
- Use with ratchet wrench or spanner to insert composite bushes
- Applications: Audi A3, VW Bora & Golf IV

Pulley Spinning



AC82-045

- For deep forged pulleys to turn off the crankshaft, camshaft, etc...
- Application: Mercedes, VW-Audi, BMW, Ford, Opel, Peugeot, Renault, Rover, Volvo, Japanese cars
- Attention: It is not a counter-holding wrench for shafts

Idler Pulley Wrench



AC82-040

- For adjusting of the toothed belt at the automatic tensioning pulley
- Especially for VW Polo Diesel, Audi 100 since 1991, Audi A6 with 2.5 l TDi engine
- Special steel 32mm
- Surface mat chrome-plated, handle plastic coated

Step Plate Adaptor Set



AC06-6384

- Special design with self-locking nut to remove & install the torque struts at front axle
- Bore size: M14 x 1.5
- Application: W171, W203, W209

AC

BE

BS

BK

ET

GT

OF

PS

TS

TT

UT

MS

AT

SD

ST

Benz M-Class Pin Wrench Socket



AC06-6361

- Pin wrench socket 3/4" drive, to secure retaining ring for ball joint replacement
- Application: 163 M-Class front & rear axles

Portable Bearing Packer



AC06-6368

- The portable bearing packer works on bearings up to 3-1/2" O.D.
- The grease stays in the tool cavity, not on your hand
- To pack a bearing, place the bearing on the piston
- Press down on the cap until the old grease is forced out and the new grease shows on top of the bearing

2-Way Hydraulic HGV Ball Joint Separator W/ Manual Screw



AC71-603C

- For separating HGV ball-joint
- Strengthened fork and lever allows for greater force to be applied
- Specially designed to be operated manually or by 12 tons
- Hydraulic ram Jaw opening capacity 70mm, Jaw width 36mm. SCM 440 material
- Can be upgraded to hydraulic power: Hydraulic power from the series patented hydraulic ram which provides up to 12 tons of hydraulic pressure that enable the user to use max power with mini effort

Ball Joint Extractors



AC06-6323A

- For splitting track-rod ends, anti-roll bar mountings, ball joints, etc...
- Size: 18mm

AC06-6323B

- Size: 23mm

AC06-6323C

- Size: 29mm

AC06-6323D

- Size: 40mm

AC06-6323E

- Size: 46mm

Belt Gauge



AC06-62136

- This tensioning gauge can be used to adjust the tension on the cam belts where the movement of the timing belt is measured by load
- Suitable for use on cam belts with various belt thickness
- Easy to use
- Clear incremental marking with knurled knob for precise measurement
- Dual scale allows reading from top or bottom of tool (large and small numbers for compatibility)

Ball Joint Extractor



AC06-6344B

- For splitting track-rod ends, anti-roll bar mountings, wheel-hub ball joints, etc
- Jaw open: 22mm
- 2-stage, 50-80mm

Universal Ball Joint Extractor



AC06-6366

- For splitting track-rod ends, anti-roll bar mountings, wheel-hub ball joints, etc
- Dimension C is infinitely adjustable so providing a wider application range
- Size: 32mm

External & Internal Restorer Files



AC06-1032-4

- Restore tool for renewing damaged thread on any diameter bolt, stud, axle or shaft file both right and left hand threads
- Design use in hide & narrow area
- Description pitch sizes: Metric file 0.80, 1.00, 1.25, 1.50, 1.75, 2.00, 2.50, 3.00

External & Internal Restorer Files



AC06-1032-5

- Restore tool for renewing damaged thread on any diameter bolt, stud, axle or shaft file both right and left hand threads
- Design use in hide & narrow area
- Description pitch sizes: SAE file 10-11-12-14-16-18-20-24

2pcs Rubber Ring Hook Tool Set



AC06-6394

- Special designed to pull the rubber ring which connected with exhaust tube
- Special angle hook attached

Brake Calliper Guidance Thread Repair Set (For Ford, Vag, Opel)



AC06-6398A-A

- For repairing the guide pin threads in the wheel bearing housing.
- With disassembly of guide pins while changing the brake pads the internal threads are frequently destroyed.
- The defective threads are repaired professionally and quickly with a heavy duty rustproof high-grade steel threaded bush.
- Contents: Replacement bushes with copper ring m 9x1.25 (packing unit 10 pcs) special core drill Special tap M9x1.25, Hex key 7mm

C-V Joint Boot Clamp Pliers



AC06-6303

- For ear type clamps
- Fits late model gm cv joint boots
- Also installs perma-quick type clamps quickly and easily
- Use for filter, cooling system and vacuum lines

Exhaust And Tailpipe Cutter



AC06-63101

- Fifteen blades effectively cut pipe so only 1/4" turn is needed for a complete cut
- Use tool to cut pipes 3/4" to 3" (19 to 76mm) in diameter
- Not for use on stainless steel

Extra Large Custom Built Bush / Bearing / Seal Driver Set



AC06-6325C

- Adjustable jaws with locking feature to suit both hexagon & octagon wheel bearing lock nuts
- Includes three sets round & three sets square of pins to suit lock nuts with pin holes
- Suitable for 6pt lock nut 1-3/4" to 5-1/4" (49-135mm) across the flats and 8pt lock nut 1-3/4" to 5-5/8" (49-143mm) across the flats
- 3 set round pin: 1/4"(6mm), 5/16"(8mm), 3/8"(10mm)

Taoer Key Set



AC06-6364

- For the steel clamps at the ball flange on VW exhaust systems
- Application: VW transporter T4 4-CLY. engine, Golf LLL, Jetta, model years 1984-1992

Master Bearing Race And Seal Driver



AC53-OT260C

- All-in-One, self-contained precision driver with no more discs to sort through or guesswork.
- Simply dial in the 3 hardened jaw construction and seat races, bearings or seals with ease.
- Durable, sturdy aluminum construction, equipped with a steel capped striker shaft handle.
- The 3 Stepped Jaws cover a range of O.D./I.D.'s from 18.5 ~ 89mm OR 0.72" ~ 3.50" inches.
- Worldwide patents and pending.

24pcs FWD Front Wheel Bearing Tool



AC110-3003024M

- Front wheel bearing adaptor set
- Forged carbon steel, hardened & black finished
- 13- 20mm(I.D.O)adaptors
- 1- 69.3-82.5mm 3 in 1 adaptor
- 1-81.3-101.3mm 3 in 1 adaptor
- 1-bolt:195mmL x 28mm
- 2-washers
- 1-nut
- 4-bearing pullers

AC

BE

BS

BK

ET

GT

OF

PS

TS

TT

UT

MS

AT

SD

ST

Fork Oil Level Gauge



AC43-4266

-For checking and adjusting the oil level on all types of forks.

Heavy-Duty Valve Spring Compressor Set



AC43-4266

-16 / 19 / 23 / 25 / 30 mm

Chain Breaker and Riveting Tool Set



AC43-7034

-Each tool is packed with the following parts:
-1 each of above tips: Spring
-Tool body: Anvil (large)
-Alignment bolt: Anvil (small)
-Push bolt: Upper tip guide for 2.2mm tip
-Handle: Lower tip guide for 2.2mm tip
-Push bolt lever: Carrying box
-Note: This tool may be used for breaking all sizes chain from number 35 to 630 but is not recommended for cutting heavy-duty type of 530 or 630 chain unless rivet head is ground off first.

Heavy Duty Adjusting Crank Case Separator Tool Set



AC43-4251

-3x M8 x P1.25 x 95L.
-1x M6 x P1.0 x 65L.
-1x M6 x P1.0 x 57L.
-1x M6 x P1.0 x 49L.
-1x M14 x P1.5 x 180L.

Flywheel Drive Puller Set



AC43-7013

-The plier connector should be fixed with the 19mm wrench.
-And take out the flywheel after the plier rotary shaft is inserted into the plier connector.

Open Disc Brake Pad Spreader



AC43-4253

-Capacity from 16.5 to 40mm.
-Useful to disjoin the small piston from the disk.

4pcs Chain Brush Kit



AC43-4260

-Cleaning agent is sprayed on exactly where you need it. Brush segments clean chain and pinions while protecting the sealing rings at the same time.
-Dirty cleaning agent runs off. Observe environmental protection regulations when disposing of the cleaning agent.
-Lubricant is applied sparingly exactly where it is needed. Brush segments spread out the lubricant evenly.
-Can be used for left-side and right-side drive.

Braking MC Chain Brush



AC43-7015

- extends the life of the chain
- U-shaped brush allows easy drain cleaning

90° Internal Snap Ring Plier



AC43-7011

-90° internal bent nose circlip pliers.
-For removing and installing the snap rings on hydraulic master cylinders on motorcycles.
-Spring loaded action for ease of use.
-Length of jaws 53mm
-Moulded handles for easy comfortable use.

Motorcycle Disc Brake Spreader



AC43-4265

- Universal motorcycle application compresses the brake pistons on most style calipers for easy pad replacement.
- Suits all front and some rear disc brakes.

17, 19, 22, 24 Hex Axle Tool



AC43-7070

- This tool fits into the internal hex on many late model sport bike axles and some dirt bikes.
- It provides four metric hex sizes: 17mm, 19mm, 22mm and 24mm 3/8" square drive on both ends and works with any 3/8" drive wrench.
- Do not exceed 90 ft/lb (122Nm) torque on this tool. It may cause tool to fail resulting in injury to user and damage to the equipment.

Portable Auxiliary Tank for Fuel-Injected Systems (1000c.c)



AC43-7074

- For use when tuning a motorcycle with the gas tank removed.
- Includes 4ft. of 1/4" fuel line & a 1/4" in-line fuel barb.
- Use deluxe auxiliary fuel tank on fuel injected motorcycles
- Tank can also be used for refilling transmission oil on some late model MX bikes.
- Holds up to 2000cc or 1/2-gallon of fluid.
- Not designed for fuel storage.
- Graduated scale located on the side of bottle allows accurate measurement of fluid volume.

Universal Crank Bearings Puller Tool Set



AC43-7053

- Material of main body: Carbon steel w/o heat treatment.
- Material of tips: Cr-Mo with heat treatment.
- Features replaceable points and spring ratchet.
- Locking mechanism to securely hold against circlip tension.
- Internal: 3-1/16" - 6-1/4".
- External: 3-1/2" - 6-1/2".
- Tip diameter: 0.12" (3mm).
- Tip: 0° / 45° / 90° 4pcs of each degree.
- 4pcs screws.
- Spread: 3-1/4" (85mm).
- Length: 16" (400mm).

Micrometro Timing For 2 Stroke Engines



AC43-4270

- An aftermarket Micrometer Top Dead Centre
- Timing Adjustment Tool.
- Settings are in mm.
- For set up of 2 stroke engines with M 14x1.25 spark plug size

Plate Pushing Tool



AC43-7063

- Plate pushing tool for clutch disassembly professional mo

Plate Pushing Tool



AC43-7060

- 20 & 24 mm

Plate Pushing Tool



AC43-7062

- To disassemble clutch ring nut
- For vesap PX-PE

Universal Fork Seal Drivers



AC43-4259

- Adjustable fork seal driver 35-45mm.

Fork Seal Driver



AC43-4258

- Size: 35-36 / 37-38 / 39-40 / 42-43 / 45-46 / 47-48 / 49-50 mm

AC

BE

BS

BK

ET

GT

OF

PS

TS

TT

UT

MS

AT

SD

ST

Steering Tube Bearing Installer Set



AC43-7072

-Instructions:

- Clean the lower bearing and the lower bearing seat so they are completely free of grease or oil.
- Place bearing on steering stem.
- Select the appropriate aluminum ring and place it on the bearing.
- Place driver tube over aluminum ring and tap down with a hammer until the bearing is properly seated.

Utensilb Per Compression Steering Race Press Set



AC43-7073

- For the correct installation of bearings on motorcycles

2pcs Rim Protector



AC43-7006

- Wheel ring protector.
- It's your good helping hand and the convenient tool while changing the tire with the weight lifter.

Clutch Spring Check Tool 155mm



AC43-7046

- Clutch spring check-tool for 50-250cc engines with Φ 125-155mm pulley.

Universal Holder



AC43-7004

- It's the essential disengaging tools for preventing the Flywheel, clutch and pulley from rotating.
- It's quite convenient that it will be done by collecting all of the tools in the same tool box after having finished using them.

Tire Lever



AC43-7007

- Length: 11" (280mm)
- Width: 1" (25mm)

Clutch Spring Check Tool 155mm



AC43-7047

- Clutch spring check-tool for 50-250cc engines with Φ 125-155mm pulley.

Pulley Holder



AC43-7005

- There are 2 adjusting holes for the minimum adjusting.
- For the durable life of the tool and for securing the object in the minimum length of the belt, please don't pull the by violence.

Chain Puller



AC43-7010

- Size: 428, 520, 525, 528, 530

Pulley Holder



AC43-7016

- Universal Pulley holder suitable for flywheel and clutch pulleys on a large range of motorcycles.
- Adjusting screw allows tool to be locked at the required size.
- PVC dipped handle gives added comfort.

Spring Hooks



AC43-7036

- Remove exhaust pipe springs, seat or tank holding springs or cotter pins.
- Length: 8-5/8" (220mm)

Chain Breaker & Riveting Tool



AC43-7037B

- This tool is a compact handy tool for chain that can be used for cutting, press fitting of connecting link plate and riveting of connecting pin by one body.

Open Brake Disk Tool



AC43-4267

- It expands the gap between the pads, making it easy to insert the disk between the pads when re-installing a caliper or wheel.
- “Sure grip” dual density handle provides a positive grip

Heavy Duty Valve Spring Compressor



AC43-7002-5

- 1-30mm-28.5mm
- 2-25mm-23.5mm
- 3-23mm-21.5mm
- 4-19mm-16.5mm
- 5-16mm-14.5mm

Open Brake Disk Tool



BC31-4255-1

- 5.2mm*1 6.2mm*1
- 5.4mm*1 6.4mm*1
- 6.5mm*1 6.6mm*1
- 5.8mm*1 6.8mm*1
- 6.0mm*1 7.0mm*1

AC

BE

BS

BK

ET

GT

OF

PS

TS

TT

UT

MS

AT

SD

ST

Universal Windshield Wiper Puller



AC108-5001

- Spindle end with brass cap to prevent damage to the windscreen wiper arm.
- Suitable for many automobiles and commercial vehicles.
- No damage to the wipers, shaft, scratching the paint, no
- Heavy execution for loosening the tightest of wiper arms.

9pcs Door Dressing & Panel Shaper Tools



AC108-5005A

- The system contains a special pneumatic hammer, 4 different pillows for different metal or aluminum thicknesses and one adapter.
- Special pillow sizes are available on demand.
- Reshape badly deformed inner panels, body lines and floors.
- Vibratory shaping takes less time and effort.
- Those different head shapes to fit all you needs
- Fits all standard air hammers.
- Replacement heads available

7pcs Special Vibro Chisel Set



AC108-5007A

- Using the special vibro chisel set turns every commercially available compressed air chipping hammer to an ideal problem solver for opening rusted screw connections and for loosening components.
- The screw loosener chisel attachment loosens screws with different profile effectively and carefully.
- The strong vibrations of the compressed air chipping hammer are transferred direct to the screw connection whereas a rotating motion is applied using a commercially available wrench at the same time.
- The hammer mandrel attachment is an amazing support with each extractor procedure (e.g. ball joint pivots)
- Furthermore, the set includes a pressure plate adapter for driving out bearings / sleeves / bushes, etc...

12pcs Door Dressing & Panel Shaper Tools



AC108-5005

- The system contains a special pneumatic hammer, 4 different pillows for different metal or aluminum thicknesses and one adapter.
- Special pillow sizes are available on demand.
- Reshape badly deformed inner panels, body lines and floors.
- Vibratory shaping takes less time and effort.
- Those different head shapes to fit all you needs
- Fits all standard air hammers.
- Replacement heads available

5pcs Door Dressing Tools



AC108-5003A

- Door dressing tools system is an European wide bending or crimping system. With pneumatic air pressure door skins, wheel arches etc. can be crimped or bent in minutes.
- The system contains a special pneumatic hammer, 4 different pillow for different metal or aluminum thicknesses and one adapter.
- Special pillow sizes are available on demand.

Wrenches For Nuts With Top Holes Tool Set



AC108-5009

- Nut Size
- 1.5 / 2.5 mm & 2.0 / 3.0 mm & 3.0 / 5.0 mm & 4.0 / 6.0 mm & 5.0 / 7.0 mm & 6.0 / 8.0 mm & 8.0 / 10.0 mm & 8.0 / 12.0 mm

7pcs Door Dressing Tools



AC108-5003

- The system contains a special pneumatic hammer, 4 different pillows for different metal or aluminum thicknesses and one adapter.
- Special pillow sizes are available on demand.

6pcs Door Dressing Tools



AC108-5003B

- Door dressing tools system is an European wide bending or crimping system. With pneumatic air pressure door skins, wheel arches etc. can be crimped or bent in minutes.
- The system contains a special pneumatic hammer, 4 different pillows for different metal or aluminum thicknesses and one adapter.
- Special pillow sizes are available on demand.

5pcs universal strut nut tool set



AC108-5023

- Nut size:
- 10.5 mm - VW Golf Rear Axle
- 12.5 mm - VW Polo Front Axle
- 14 mm - Mercedes Benz, W209 (C-class), W209 (CLK)
- 14.5 mm - Polo, Golf, Passat, Audi 80
- 14.5 mm - Austin Maestro

Pneumatic Bolt Removal Tool Vibro Impact



AC108-5025

-The vibrating pin transfers the impact pulse to the spanner face of the bolt or nut to be released. Rust becomes dislodged by the vibration, so that the bolt or nut can be removed.

- For operation with impact hammer
- Ergonomically shaped handle
- Requires only minimum force.
- High-strength design
- Quick loosening of heavily rusted nuts
- Length: 190mm
- Width: 65mm
- Clear width: 27mm

7pcs Special Vibro Chisel Set



AC108-5021

- For the extraction of clamping screws with the chisel hammer set.
- It is important to observe the operating instructions as well as the safety instructions for pneumatic tools.

5pcs Special Air Hammer Chisel Set



AC108-5027B

- Ideal for removing ball joints and tie rod ends, cutting bolts and revets, shock absorber and muffler work.
- Perfect for front end shops, muffler shop, body shops, truck and bus repair and motorcycle shops.

8pcs Special Vibro Chisel Set



AC108-5007

-Using the special vibro chisel set turns every commercially available compressed air chipping hammer to an ideal problem solver for opening rusted screw connections and for loosening components.

-The screw loosener chisel attachment loosens screws with different profile effectively and carefully.

-The strong vibrations of the compressed air shipping hammer are transferred direct to the screw connection whereas a rotating motion is applied using a commercially available wrench at the same time.

-The hammer mandrel attachment is an amazing support with each extractor procedure

-Furthermore, the set includes a pressure plate adapter for driving out bearings / sleeves / bushes etc

5pcs universal strut nut tool set



AC108-5029

- A- 6" / 152.4mm - Chevrolet
- B- 9" / 228.6mm - Olds mobile
- C- 9" / 228.6mm - Olds mobile
- D- 9" / 228.6mm - Olds mobile
- E- 16 3/4" / 425.5mm - Trucks

7pcs Special Air Hammer Chisel Set



AC108-5027A

-Ideal for removing ball joints and tie rod ends, cutting bolts and revets, shock absorber and muffler work.

-Perfect for front end shops, muffler shops, body shops, truck and bus repair and motorcycle shops.

6pcs Impact Ball Joint Separator Set



AC108-5031

- 42mm(1.65") open x 178(L)mm(7")
- 35mm(1.38") open x 178(L)mm(7")
- 30mm(1.18") open x 178(L)mm(7")
- 24mm(0.95") open x 178(L)mm(7")
- 20mm(0.79") open x 178(L)mm(7")

5pcs Impact Ball Joint Separator Set



AC108-5031A

- 42mm(1.65") open x 178(L)mm(7")
- 35mm(1.38") open x 178(L)mm(7")
- 30mm(1.18") open x 178(L)mm(7")
- 24mm(0.95") open x 178(L)mm(7")
- 20mm(0.79") open x 178(L)mm(7")

8pcs Special Air Hammer Chisel Set



AC108-5027

-Ideal for removing ball joints and tie rod ends, cutting bolts and revets, shock absorber and muffler work.

-Perfect for front end shops, muffler shops, body shops, truck and bus repair and motorcycle shops.



AC

BE

BS

BK

ET

GT

OF

PS

TS

TT

UT

MS

AT

SD

ST

5pcs Impact Ball Joint Separator Set



AC108-5031B

- 42mm(1.65") open x 240(L)mm(9.5")
- 35mm(1.38") open x 240(L)mm(9.5")
- 30mm(1.18") open x 240(L)mm(9.5")
- 24mm(0.95") open x 240(L)mm(9.5")
- 20mm(0.79") open x 240(L)mm(9.5")

7pcs Air Hammer Pneumatic Tool Set



AC108-5033

- A 7" x 24mm Impact ball joint separator
- B 7" x 20mm Impact ball joint separator
- C 8" Splitting tool
- D 38.5mm Diameter body smoother hammer
- E 25mm Hammer
- F Track rod hammer
- G Air hammer

6pcs Air Hammer Pneumatic Tool Set



AC108-5033A

- A 7" x 24mm Impact ball joint separator
- B 7" x 20mm Impact ball joint separator
- C 8" Splitting tool
- D 38.5mm Diameter body smoother hammer.
- E 25mm Hammer
- F Track rod hammer

5pcs Impact Ball Joint Separator Set



AC108-5035

- To remove & install brake pad. Available riveter punch sizes : 3/32"-1/8"-5/32"-3/16"-1/4"
- A Air needle scaler
- B 3/32" Rivet punch
- C 1/8" Rivet punch
- D 5/32" Rivet punch
- E 3/16" Rivet punch
- F 1/4" Rivet punch
- G Flat chisel
- H 25mm Diameter body smoother hammer
- I Safety chuck
- J Mini air hammer

Rusted Shock And Strut Bolts Are No Match For These Air Hammer Drifts



AC108-5039

- XL air hammer drift set
- 7 in. ling parallel shaft design won't get stuck in deep holes.
- Set includes the six most commonly used sizes
- Offers the extra driving force of an air hammer where needed

Four-Way Pick Set



AC108-5041A

- Corkscrew style "O" tip for removing O-rings

Four-Way Pick Set

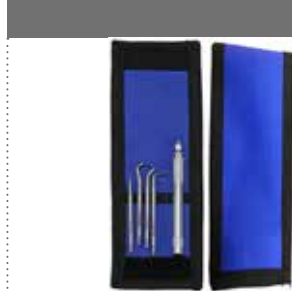

AC108-5041

- Knurled 5/16" x 5" (7.9 x 127 mm)
- Aluminum sure-grip handle
- Four 3-1/2" (88.9mm) knurled, tempered steel picks.
- Corkscrew style "O" tip for removing O-ring

Four-Way Pick Set



AC108-5043A

- Material SUS 420
- 9" Hook pick
- 9" Angle pick
- 9" 90° Degree pick
- 9" Straight pick
- 9" Complex pic
- 9" Combination pick
- 9" Double angle pick

8pcs Hook And Pick Set



AC108-5043

- Material SUS 420
- 9" Hook pick
- 9" Angle pick
- 9" 90° Degree pick
- 9" Straight pick
- 9" Complex pic
- 9" Combination pick
- 9: Double angle pick
- Aluminum

5pcs Pick & Hook Extra-Long Set



AC108-5045

- Material 6150
- 15" Straight pick
- 15" Double angle pick
- 15" 90° degree pick
- 15" offset pick
- 15" hook pick

Chipping Hammer Tool Set



AC108-5037

- 12 oz Chipping hammer
- 16 oz Chipping hammer

14pcs Special Vibro Chisel Set



AC108-5047

- 74mm large flat hammer
- 63mm large concave hammer
- 38mm medium flat hammer
- 1/2"Dr. adaptor hammer
- Adaptor shaft hammer
- 25mm hammer
- Track rod hammer
- 7" x 24mm impact ball joint separator
- 7" x 20mm impact ball joint separator
- 20mm flat chisel
- Point chisel
- 38.5mm diameter body smoother hammer
- 10pcs spare o-ring
- Air hammer

13pcs Special Vibro Chisel Set



AC108-5047A

- 74mm large flat hammer
- 63mm large concave hammer
- 38mm medium flat hammer
- 1/2" Dr. adaptor hammer
- Adaptor shaft hammer
- 25mm hammer
- Track rod hammer
- 7" x 24mm impact ball joint separator
- 7" x 20mm impact ball joint Set
- 20mm flat chisel
- Point chisel
- 38.5mm diameter body smoother hammer
- 10pcs spare o-rings

11pcs Special Vibro Chisel Set



AC108-5047B

- 63mm large concave hammer
- 1/2"Dr. adaptor hammer
- Adaptor shaft hammer
- 25mm hammer
- Track rod hammer
- 7" x 24mm impact ball joint separator
- 7" x 20mm impact ball joint separator
- 20mm flat chisel
- Point chisel
- 38.5mm diameter body smoother hammer
- Air hammer

Special Chisel Hammer Bar



AC108-5051

- Convert air chisels and other accessories with the universal air hammer shank to hand use.
- No air required, full use of all air hammer adaptors, for use with standard impact hammers.

Vibro Power Exhaust Slitting Chisel



AC108-5049-20/21

- Impact exhaust slitting chisel
- Cancel separator compressed air exhausts

Pin Pouch, Clamp Bolt To Be Operated With Air Hammer



AC108-5049-48

- Extra long shaft with center ball on tip.
- After separating the hexagon screw head, the clamp bolt is driven out of the axle housing. The high impact rate combined with powerful impacts breaks up corrosion and allows rust remover to enter.
- ø6.5mm x 110L x 178mmL
- AUDI / VW aluminum twin steering knuckles.

Wheel Stud Alignment Guide Tool



AC108-5053

- Assists when mounting wheels, especially late models with long lug bolts.
- M12 x 1.25 x 2pcs
- M12 x 1.5 x 2pcs
- M12 x 1.75 x 2pcs
- M14 x 1.5 x 2pcs
- M14 x 1.25 x 2pcs

Gasket Scraper



AC108-5055

- 13" (330mm) scrapers have 38mm wide, bevel-edged blades
- Comfortable Contoured Handle
- For cleaning cylinder heads and removing old sealant and carbon deposits

AC

BE

BS

BK

ET

GT

OF

PS

TS

TT

UT

MS

AT

SD

ST

8pcs Pneumatic Wheel Bearing And Tire Repair Kit Set



AC108-5057

-Designed to allow the use of an air hammer for wheel bearing and tire repair work of motorcycle.

7pcs Pneumatic Wheel Bearing And Tire Repair Kit Set



AC108-5057A

-Designed to allow the use of an air hammer for wheel bearing and tire repair work of motorcycle

4pcs Pneumatic Tire Repair Kit Set



AC108-5057B

-Designed to allow the use of an air hammer for tire repair work

3pcs Pneumatic Tire Repair Kit Set



AC108-5057C

-Designed to allow the use of an air hammer for tire repair work

Windshield Wiper Adjusting Tool



AC108-5061

-For angular adjustment of the windshield wiper blades.

-Not suitable for aero twin wipers

Pneumatic Power Bar Impact Wrench



AC108-5063

-Length 560mm

-1/2" square driver



Special Vibro Chisel Set



AC108-5065

-Adaptor shaft hammer

-ø 29mm track rod hammer

-ø 29mm copper hammer

-ø 29mm aluminum hammer

-ø 29mm polyoxymethylene(POM) hammer

-ø 38mm medium flat hammer

Work Stand With Tray



AC90-01

-Folded size: 1120(L) x 250(W) x 1170(H) mm
-Unfolded size: 1120(L) x 710(W) x 1000(H) mm

Adjustable Work Stand



AC90-03

-Folded size: 600(L) x 300(W) x 1104(H) mm
-Unfolded size: 600(L) x 870(W) x 660(H) mm

Adjustable Work Stand With Extension Rod



AC90-17

-Folded size: 600(L) x 300(W) x 1140(H) mm
-Unfolded size: 600(L) x 870(W) x 660(H) mm

Adjustable Work Stand



AC90-02

-Folded size: 1120(L) x 300(W) x 1104(H) mm
-Unfolded size: 1120(L) x 870(W) x 660(H) mm

Adjustable Work Stand



AC90-10

-Folded size: 920(L) x 160(W) x 1150(H) mm
-Unfolded size: 920(L) x 970(W) x 620(H) mm

Fixed Display Shelf For Glass



AC90-18

-Erect supporter size: 560(L)mm
-Cross supporter size: 700(L)mm

Adjustable Work Stand With Castor



AC90-07

-Folded size: 760(L) x 300(W) x 1230(H) mm
-Unfolded size: 760(L) x 900(W) x 870(H) mm

Multi-Function Display Shelf With Castor



AC90-29

-Supporter size: 1200(L) x 700(W) x 635(H) mm

Adjustable Work Stand With Castor



AC90-25

-Supporter size: 1240(L) x 930(W) x 1060(H) mm

AC

BE

BS

BK

ET

GT

OF

PS

TS

TT

UT

MS

AT

SD

ST

Adjustable Work Stand



AC90-28

-Folded size: 920(L) x 160(W) x 1150(H) mm
-Unfolded size: 920(L) x 970(W) x 620(H) mm

Display Shelf With Castor



AC90-19L

-L size: 1200(L) x 800(W) x 1900(H) mm
-S size: 800(L) x 800(W) x 1900(H) mm

Multi-Function Display Shelf With Castor



AC90-20-1L

-Supporter size: 1200(L) x 760(W) x 1850(H) mm
-Back-Supporter size: 940(L) x 760(W) x 635(H) mm

Fixed Display Shelf



AC90-15

-Erect supporter size: 720(L)mm
-Cross supporter size: 635(L)mm

Fixed Display Shelf



AC90-20L

-Supporter size: 1200(L) x 760(W) x 1850(H) mm

Display Shelf With Castor



AC90-23

-Supporter size: 600(L) x 940(W) x 880(H) mm

Adjustable Folding Stand With Castor



AC90-21

-Folded size: 880(L) x 240(W) x 1150(H) mm
-Unfolded size: 880(L) x 130(W) x 910(H) mm

Multi-Function Spray Gun Shelf W/Magnetic Function



AC90-31

Spray Gun Shelf With Magnetic Function



AC90-08

Dispaly Shelf With Castor



AC90-20S

-Supporter size: 1200(L) x 760(W) x 980(H) mm

Two-Way Folding Display Shelf With Castor



AC90-12S

-Supporter size: 1200(L) x 1200(W) x 1090(H) mm

Adjustable Driver Stand



AC90-05

-Supporter size: 780(L) x 900(W) x 2200(H) mm

Multi-Function Adjustable Work Stand With Castor



AC90-42

-Supporter size: 2020(L) x 750(W) x 94(H) mm

One-Way Folding Display Shelf With Castor



AC90-13S

-Supproter size: 1200(L) x 750(W) x 1090(H) mm

Adjustable Driver Stand



AC90-16

-Supporter size: 900(L) x 700(W) x 2000(H) mm

Multi-Function Adjustable Work Stand With Castor



AC90-04

-Supporter size: 950(L) x 700(W) x 1030(H) mm

Adjustable Work Stand



AC90-43

-Supporter size: 610(L) x 420(W) x 950(H) mm

AC

BE

BS

BK

ET

GT

OF

PS

TS

TT

UT

MS

AT

SD

ST

One-Way Folding Display Shelf With Castor



AC90-13

-Supporter size: 1200(L) x 750(W) x 2150(H) mm

Adjustable And Fixed Crutch With Castor



AC90-27

-Supporter size: 680(L) x 700(W) x 700(H) mm
-Adjustable length (height): 700-1300 mm

Adjustable Work Stand



AC90-11

-Supporter size: min 920(L) x 160(W) x 620(H) mm ; max 920(L) x 970 (W) x 1150(H) mm

Painting Stand With Castor



AC90-24

-Supporter size: 2040(L) x 900(W) x 2110(H) mm

Adjustable Work Stand



AC90-43S

-Supporter size: 610(L) x 420(W) x 380(H) mm

Display Shelf With Castor



AC90-32

-Supporter size: 1520(L) x 452(W) x 1060(H) mm

Multi-Funtion Spray Gun Shelf W/Magnetic Function



AC90-33

Mountin Bracket



AC90-39

-Supporter size: min 650(L) - mix 1500(L) mm

Adjustable Work Stand With Extension Rod



AC90-34

Adjustable Folding Stand With Castor



AC90-35

Two-Way Folding Display Shelf With Castor



AC90-12

-Supporter size: 1200(L) x 1200(W) x 2150(H) mm

One-Way Folding Display Shelf With Castor

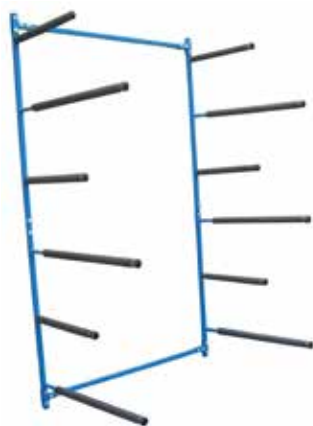

AC90-14

-Supporter size: 740(L) x 1140(W) x 1980(H) mm / 80kg

Paper Cutting Tool



AC90-30

-Supporter size: 770(L) x 560(W) x 1040(H) mm

Adjustable Folding Stand With Castor



AC90-37

-Supporter size: min 600(L) x 24(W) x 115(H) mm ; max 600(L) x 130(W) x 115(H) mm

Spray Gun Shelf With Magnetic Function



AC90-09

Multi-Function Adjustable Work Stand



AC90-38

-Supporter size: 1030(L) x 780(W) x 1750(H) mm

Adjustable Work Stand



AC90-40

-Supporter size: 800(L) x 850(W) x 670(H) mm

AC

BE

BS

BK

ET

GT

OF

PS

TS

TT

UT

MS

AT

SD

ST

Iveco Axle Nut Socket 110mm



AC108-9001A

- Six sided drive SW 36
- Positive drive of the axle nut
- Any extensive slipping is avoided
- Milled out profile
- Robust execution
- Can be used with an impact wrench or torque wrench
- Special steel

Benz Axle Nut Socket 95mm



AC108-9003A

- Six sided drive SW 36
- Positive drive of the axle nut
- Any extensive slipping is avoided
- Milled out profile
- Robust execution
- Can be used with an impact wrench or torque wrench
- Special steel

Groove Nut Socket For Differential Nuts



AC108-9003D

- With Hexagon drive SW 32
- Removal and installation of differential nuts
- High accuracy of fit
- Robust execution
- Suitable for high tightening and loosening torque

Iveco Axle Nut Socket 98mm



AC108-9001B

- Six sided drive SW 36
- Positive drive of the axle nut
- Any extensive slipping is avoided
- Milled out profile
- Robust execution
- Can be used with an impact wrench or torque wrench
- Special steel

Benz Rear Axle Nut Socket 105-125mm



AC108-9003B

- Internal square drive to DIN 3121 / ISO 1174
- Rigid locating tube
- High accuracy of fit
- Extremely robust execution
- Suitable for high tightening and loosening torque
- Special steel

MAN Front Axle Nut Socket 133-145mm



AC108-9005A

- Internal square drive to DIN 3121 / ISO 1174
- Six sided drive SW 60
- Optional with sleeve locating tube
- High accuracy of fit
- Extremely robust execution
- Suitable for high tightening and loosening torque
- Special steel

Iveco Hub Nut Wrench With Guide Edge, Hexagon 90mm



AC108-9001C

- Drive 3/4"
- Positive drive of the axle nut
- Any extensive slipping is avoided
- Milled out profile
- Robust execution
- Can be used with an impact wrench or torque wrench

Benz Groove Nut Socket For Rear Axle Nut



AC108-9003C

- With hexagon drive SW 32
- For the dismantling and assembly of the rear axle nut
- High accuracy of fit
- Robust execution
- Suitable for high tightening and loosening torque
- Drive tube ø 35mm

MAN Front Axle Nut Socket 133-145mm



AC108-9005B

- Six sided drive SW 60
- Optional with sleeve locating tube
- High accuracy of fit
- Extremely robust execution
- Suitable for high tightening and loosening torque
- Special steel

MAN TGA Front Axle Nut Socket 101-110mm



AC108-9005C

- Internal square drive to DIN 3121 / ISO 1174
- Six sided drive SW 60
- High accuracy of fit
- Extremely for high tightening and loosening torque
- Special steel

MAN Front Wheel Hub Extractor



AC108-9005D

- Internal square drive to DIN 3121 / ISO 1174
- Six sided drive SW 60
- High accuracy of fit
- Extremely for high tightening and loosening torque
- Special steel

MAN Front Wheel Hub Extractor



AC108-9005E

- To install front wheel hub of man
- There is a bearing inside the tool to save power
- Use this axle with spanner spin the screw
- Robust execution
- Very convenient tools
- European truck repair tool

MAN Axle Bearing Extractor



AC108-9005G

- For replace MAN truck hub bearing and remove the old bearings essential tool
- Turn the screw to remove the bearing
- To be used with wrench
- European truck repair tool
- Specialty tools

MAN Tranctor Axle Bearing Extrator



AC108-9005H

- For replace MAN truck hub bearing and remove the old bearings essential tool
- Turn the screw to remove the bearing
- To be used with wrench
- European truck repair tool
- Specialty tools

MAN Front Wheel Hub Remover 166mm



AC108-9005I

- When MAN axle bearing is stuck due to it's over heat, use this tool with air wrench for labor saver and easier removal
- Use this axle with spanner spin the screw
- Extremely robust execution
- European truck repair tool
- Very convenient tools

MAN Truck Transmission Socket 53.5mm



AC108-9005F

- This special socket removes
- Transmission nut on MAN trucks

Steering Mechanism Oil Seal Socket



AC108-9005J

- To replace steering mechanism oil seal by loosen / tighten the nut
- It might damage the related parts while replacing the oil seal without this tool

Oil Filter Wrench For MAN



AC108-9005K

- 1/2"DR. 135mm 18points

Extension Tube For MAN TGA Rear Axle



AC108-9005L

- For the removal and installation of wheel hubs
- Extension tube for the protection of the wheel bearing and threaded bolts
- With knurling and bore for toggle lever

AC

BE

BS

BK

ET

GT

OF

PS

TS

TT

UT

MS

AT

SD

ST

Sleeve Locating Tube 60-67mm



AC108-9007A

- Practical connector system with fixing screw
- Usably for different groove socket nuts (module systems)
- Enables stable work position
- Prevents slippage of the socket
- Extremely robust execution
- Change through loosening of the grub screw on the hexagon
- Special steel

BPW Rear Hubcap Nut Socket 109mm



AC108-9009C

- Special heavy duty eight point socket to suit BPW rear axle hub retaining cap nuts found on later model Japanese commercial trucks, tractors and other automotive industrial equipment
- Socket for the rear axle cover
- Male hex drive: 1-5/8" (41mm)
- Size: 4-5/16" (109mm) 8 point opening

BPW Axle Nut Socket 65mm



AC108-9009D

- For the dismantling and assembly of BPW axle nuts
- Extremely versatile
- Flat oval form
- Suitable for exact torque with a 3/4" square drive
- For machinery usage
- Special steel

Sleeve Locating Tube 54-60mm



AC108-9007B

- Practical connector system with fixing screw
- Usably for different groove socket nuts (module systems)
- Enables stable work position
- Prevents slippage of the socket
- Extremely robust execution
- Change through loosening of the grub screw on the hexagon
- Special steel

BPW Rear Hubcap Nut Socket 111mm



AC108-9009B

- Special heavy duty oval shape socket with two flats on the side to suit BPW rear axle hub retaining cap nuts found on later model Japanese commercial trucks, tractors and other automotive
- For extracting the rear axle cover
- Male hex drive: 1-5/8" (41mm)
- Size: 4-3/8" (111mm) across the flats

BPW Trailer Rear Wheel Socket 95mm



AC108-9009E

- For extracting the rear axle cover
- Special steel

Sleeve Locating Tube 46-52mm



AC108-9007C

- Practical connector system with fixing screw
- Usably for different groove socket nuts (module systems)
- Enables stable work position
- Prevents slippage of the socket
- Extremely robust execution
- Change through loosening of the grub screw on the hexagon
- Special steel

BPW Rear Hubcap Nut Socket 120mm



AC108-9009A

- Special heavy duty eight point socket to suit BPW rear axle hub retaining cap nuts found on later model Japanese commercial trucks, tractors and other automotive industrial equipment
- Male hex drive: 1-5/8" (41mm)
- Size: 4-3/4" (120mm) 8 point opening

BPW Socket 37mm



AC108-9009F

- Special heavy duty eight point socket to suit BPW rear axle hub retaining cap nuts found on later model Japanese commercial trucks, tractors and other automotive industrial equipment
- Size: 37mm

Anti-Lock Braking System(ABS) Reamer(for commercial vehicles)



AC108-9005M

- For cleaning the ABS sensor receptacle e.g. on all MAN commercial vehicles
- Before refitting the new ABS sensor it is advisable to clean the ABS sensor receptacle
- Trouble-free removal of deposits (dirt, corrosion and other residues) from the ABS sensor receptacle

BPW Axle Extractor 98mm



AC108-9009J

- Use this axle with spanner spin the screw
- Extremely robust execution
- Flat oval form
- European truck repair tool
- Special steel

BPW Trailer Rear Wheel Socket (8 Point 110mm)



AC108-9009L

- Socket for the rear axle cover
- Size: 3/4"DR. 110mm 8 point opening
- Oval shaped

BPW Axle Extractor 136mm



AC108-9009I

- Use this axle with spanner spin the screw
- Extremely robust execution
- Flat oval form
- European truck repair tool
- Special steel

BPW Axle Extractor 125mm



AC108-9009K

- Use this axle with spanner spin the screw
- Extremely robust execution
- Extremely versatile
- Europe truck repair tool
- Special steel

BPW Trailer Rear Wheel Socket (8 Point 110mm)



AC108-9009L-A

- Socket for the rear axle cover
- Size: 1"DR. 110mm 8 point opening
- Oval shaped

BPW Brake Linkage Adjuster Extractor



AC108-9009H

- Use this axle with spanner spin the screw
- Extremely robust execution
- Flat oval form
- European truck repair tool
- Special steel

BPW Brake Linkage Adjuster Extractor



AC108-9009G

- Substantial construction for drawing off firmly sitting BPW brake linkage adjusters
- Suitable for older and automatic linkage adjusters
- Special steel

BPW Trailer Rear Wheel Socket (8 Point 110mm)



AC108-9009M

- Removes the lid of axle on BPW 12 tons with 9009M before using this tool
- This is for removing the fixed nut then replace the new bearing with adjustable torque wrench
- Please follow the standard operation manual of origin
- Special steel

AC

BE

BS

BK

ET

GT

OF

PS

TS

TT

UT

MS

AT

SD

ST

**BPW 6.5-9 Tons Roller Bearing
Axle Nut Socket 65mm**



AC108-9009N

- Removes the lid of axle on BPW 6.5-9 tons with 9009N before using this tool
- This is for removing the fixed nut then replace the new bearing with adjustable torque wrench
- Please follow the standard operation manual of origin
- Special steel

**SCANIA Front Wheel Shock
Absorber Spring Washer Socket**



AC108-9011B

- This special socket removes
- European truck repair tool

**SCANIA Rear Wheel Nut Socket
100mm**



AC108-9011E

- Control the nut with slide rod to adjust bearing
- This eight sided 100mm socket is specifically for rear wheel nut sockets on SCANIA trucks

**BPW 16 Tons Roller Bearings
Axle Nut Socket 85mm**



AC108-90090

- 6 point socket profile
- With 3/4" square drive
- Extremely versatile
- Suitable for exact torque
- For machinery usage

**SCANIA Rear Axles Damper Rod
Socket**



AC108-9011C

- This special socket removes
- European truck repair tool

**SCANIA Rear Wheel Shock
Absorber Spring Washer
Removal Socket**



AC108-9011F

- This special socket removes
- European truck repair tool

SCANIA Toothed Socket 72mm



AC108-9011A

- Suitable for SCANIA Transmissions
- For loosening and tightening of the retaining nut on the transmission main shaft
- SCANIA transmission clutch front main shaft socket

**SCANIA Front Wheel Nut Socket
80mm**



AC108-9011D

- This eight sided 80mm socket is specifically for front wheel nut sockets on SCANIA trucks
- SCANIA front wheel nut socket

**SCANIA Truck (310/320)
Transmission Socket (3/4"DR.)**



AC108-9011G

- This special socket removes
- European truck repair tool

SCANIA 8-Speed Bus Transmission Nut Socket



AC108-9011H

- This special socket removes
- Transmission nut on SCANIA Bus 8-Speed
- 3/4"DR. 58mm

SCANIA 10 Wheels Cab Third Axle Nut Socket



AC108-9011K

- Control the nut with slide rod to adjust bearing
- This eight sided 95mm socket is specifically for rear wheel nut sockets on SCANIA, YORK, FUSO trucks
- 3/4"DR. 8 points 95mm

1/2"DR. SCANIA Camshaft Rotator



AC108-9011M

- Allows the engine crank to be manually adjusted
- Allows pinpoint accuracy calibration
- Ideal for adjustments to the engine

SCANIA Transmission Clutch Front Main Axle Nut Socket



AC108-9011I

- This special socket removes
- For extracting / installing the front main of transmission clutch nut on SCANIA truck with ten speeds automatic transmission
- 3/4"DR. 64mm

SCANIA 10 Wheels Cab Third Axle Nut Socket



AC108-9011K-A

- Control the nut with slide rod to adjust bearing
- This eight sided 95mm socket is specifically for rear wheel nut sockets on SCANIA, YORK, FUSO trucks
- 1"DR. 8 point 95mm

SCANIA Transmission Back Oil Seal Installer



AC108-9011N

- Sealing ring installation aid for manual use
- For damage free mounting
- Extremely versatile

SCANIA Front Wheel Nut Socket 80mm



AC108-9011J

- This eight sided 80mm socket is specifically for front wheel nut sockets on SCANIA trucks
- SCANIA front wheel nut socket

SCANIA Crankshaft Rear Oil Seal Installer (310/320)



AC108-9011L

- Add new oil seal onto crankshaft
- Put 9011L above the oil seal and hit it to force oil seal install to the right place

SCANIA Front Wheel Nut Socket 80mm



AC108-9011O

- Positive drive of the axle nut
- Any extensive slipping is avoided
- Milled out profile
- Robust execution
- Can be used with an impact wrench or torque wrench

AC

BE

BS

BK

ET

GT

OF

PS

TS

TT

UT

MS

AT

SD

ST

SCANIA (340) Electromagnetic Injection Valve Cap Socket



AC108-9011P

- 1/2"DR. 8 point 38mm
- For tightening & loosening the electromagnetic injection valve cap

Groove Nut Socket With 8 Studs (SCANIA 420)



AC108-9011Q

- With 3/4" square drive to DIN 3121/ISO 1174
- Special profile with 8 external studs
- Positive drive of the axle nut
- Any extensive slipping is avoided
- Milled out profile
- Robust execution
- Can be used with an impact wrench or torque wrench

SCANIA Front Wheel Nut Socket 80mm



AC108-9011R

- Positive drive of the axle nut
- Any extensive slipping is avoided
- Milled out profile
- Robust execution
- Can be used with an impact wrench or torque wrench

BENZ & MAN Clamp Nut Socket 56mm



AC108-9013A

- For professional loosening and tightening
- Extremely versatile
- Rectangular form
- Usably with rectangular clamp nuts on the axle stub
- Suitable for exact torque with a 3/4" square drive
- Milled out profile
- For machinery usage
- Special steel

BENZ & MAN Clamp Nut Socket 60mm



AC108-9013B

- For professional loosening and tightening
- Extremely versatile
- Rectangular form
- Usably with rectangular clamp nuts on the axle stub
- Suitable for exact torque with a 3/4" square drive
- Milled out profile
- For machinery usage
- Special steel

MAN & BENZ Truck Diesel Injection Valve Socket



AC108-9013F

- Remove and install diesel injection valve
- Barreled shape
- European truck repair tool
- Specialty tools

BENZ & MAN Clamp Nut Socket 56mm



AC108-9013C

- Internal square drive to DIN 3121 / ISO 1174
- Rigid locating tube
- Optional with expander sleeve (bayonet locking system)
- High accuracy of fit
- Extremely robust execution
- Suitable for high tightening and loosening torque
- Special steel

BENZ & MAN Rear Axle Nut Socket 95-115mm



AC108-9013D

- Internal square drive to DIN 3121 / ISO 1174
- Optional with sleeve locating tube
- High accuracy of fit
- Extremely robust execution
- Suitable for high tightening and loosening torque
- Special steel

MAN & BENZ Drive Axle Nut Socket 3/4"DR. H60 6 Teeth



AC108-9013E

- For removing the drive axle nut
- Use the tool to remove the drive shaft nut
- European truck repair tool
- Flat oval form
- Special steel

MAN & BENZ Differential Rear Nut Socket 3/4"DR.



AC108-9013G

- To remove the differential rear nut
- High accuracy of fit
- Six sided drive
- Flat oval form
- European truck repair tool
- Special steel

SCANIA / BENZ Wrench Socket (Fluid Reservoir On Condenser)



AC108-9013N

- For screw plug removal and installation on fluid reservoir on condenser
- Also used for SCANIA front wheel plastic cover
- With 1/2" drive, hex 27mm

Extension Tube For The Rear Axle (R)



AC108-9013K

- With hexagon drive SW 41
- For the removal and installation of wheel hubs
- For the protection of the wheel bearing and threaded bolts
- Suitable for right and left handed threads

Truck Position Sensor Socket (27mm 8 point 1/2"DR.)



AC108-9013H

- For removing / replacing truck position sensor
- The tool is not allowed to work with air wrench

Engine Crank Alignment



AC108-9013I

- Allows the engine crank to be manually adjusted
- Allows pinpoint accuracy calibration
- Adjusting screw in the clutch housing
- Ideal for adjustments to the engine

Extension Tube For The Rear Axle (L)



AC108-9013L

- With hexagon drive SW 41
- For the removal and installation of wheel hubs
- For the protection of the wheel bearing and threaded bolts
- Suitable for right and left handed threads

Flywheel Rotating Tool With One Sprocket



AC108-9013M

- This tool allows the accurate rotating of the engine for valve setting or other maintenance and service work

Engine Crank Alignment



AC108-9013J

- Allows the engine crank to be manually adjusted
- Allows pinpoint accuracy calibration
- Adjusting screw in the clutch housing
- Ideal for adjustments to the engine

AC

BE

BS

BK

ET

GT

OF

PS

TS

TT

UT

MS

AT

SD

ST

Ball Joint-Puller Bell VIBRO-IMPACT 23mm



AC108-9015-23

- Pressure pieces in the spindle rotating mounted
- Spindle suitable for impact wrenches
- Less space required
- Cast forged execution
- Special steel

Ball Joint-Puller Bell VIBRO-IMPACT 30mm



AC108-9015-30

- Pressure pieces in the spindle rotating mounted
- Spindle suitable for impact wrench
- Less space required
- Cast forged execution
- Special steel

Ball Joint-Puller Bell VIBRO-IMPACT 39mm



AC108-9015-39

- Pressure pieces in the spindle rotating mounted
- Spindle suitable for impact wrenches
- On car maintenance
- The best tool for removing truck ball joint
- No damage to ball joint and related parts
- Cast forged execution
- Special steel

Ball Joint-Puller Bell VIBRO-IMPACT 25mm



AC108-9015-25

- Pressure pieces in the spindle rotating mounted
- Spindle suitable for impact wrenches
- Less space required
- Cast forged execution
- Special steel

Ball Joint-Puller Bell VIBRO-IMPACT 32mm



AC108-9015-32

- Pressure pieces in the spindle rotating mounted
- Spindle suitable for impact wrench
- Less space required
- Cast forged execution
- Special steel

Ball Joint-Puller Bell VIBRO-IMPACT 39mm



AC108-9015-39A

- Pressure pieces in the spindle rotating mounted
- Spindle suitable for impact wrenches
- On car maintenance
- The best tool for removing truck ball joint
- No damage to ball joint and related part
- Cast forged execution
- Special steel

BENZ Actors Pitman Arm Puller (42mm)



AC108-9015-42

- Pressure pieces in the spindle rotating mounted
- Save time and labor
- No need to destroy the pitman arm
- Cast forged execution
- Special steel

Ball Joint-Puller Bell VIBRO-IMPACT 35mm



AC108-9015-35

- The ball joint remover has a ball bearing pressure pack and is used with an impact wrench. With the pressure and impact moment great loosening torque is achieved.
- Optimal positioning between suspension arm and axle casing
- Mounted spherical centering point
- Retrofit bar hydraulic pressure spindle

SCANIA Pitman Arm Puller 58mm



AC108-9015-58

- To use on pitman arm of European trucks
- No need to destroy the pitman arm
- Cast forged execution
- Special steel

**BENZ Actros Pitman Arm Puller
42mm (With Window)**



AC108-9015-42A

- With 3/4" square drive
- Spindle suitable for impact wrenches
- High release force due to rotary shock pulse with impact wrench
- Cap with window for puller for drop arm with large reach
- Cast forged execution
- Special steel

**SCANIA Pitman Arm Puller
58mm**



AC108-9015-58A

- With 3/4" square drive
- Spindle suitable for impact wrenches
- High release force due to rotary shock pulse with impact wrench
- Cap with window for puller for drop arm with large reach
- Cast forged execution
- Special steel

**MAN (FE410A/FE414) Pitman
Arm Puller**



AC108-9015-67

- The tool is designed for extracting pitman arm of MAN.
- It is different from traditional puller that prevents pitman arm from damage
- Use H6 70mm socket to remove the fixed nut on the pitman arm before using this tool
- Cast forged execution
- Special steel

**Ball Joint-Puller Bell VIBRO-
IMPACT 47mm**



AC108-9015-47

- Pressure pieces in the spindle rotating mounted
- Spindle suitable for impact wrenches
- Less space required
- Cast forged execution
- Special steel

**Ball Joint-Puller Bell VIBRO-
IMPACT 62mm**



AC108-9015-62

- Pressure pieces in the spindle rotating mounted
- Spindle suitable for impact wrenches
- Less space required
- Put is on steering mechanism pitman arm, then take pitman arm apart
- Cast forged execution
- Special steel

SAF Axle Nut Socket 85mm



AC108-9019B

- Six sided drive SW 36
- Positive drive of the axle nut
- Any extensive slipping is avoided
- Milled out profile
- Robust execution
- Can be used with an impact wrench or torque wrench

**Ball Joint-Puller Bell VIBRO-
IMPACT 65mm**



AC108-9015-65

- Pressure pieces in the spindle rotating mounted
- Spindle suitable for impact wrenches
- Less space required
- Cast forged execution
- Special steel

SAF Axle Nut Socket 140mm



AC108-9019A

- Positive drive of the axle nut
- Robust execution
- Can be used with an impact wrench
- Ideally suited for brake restoration working
- Forward tension with SW 32mm is at 150 N-m
- Angle of rotation 20-30 with SW 46
- Special steel

**Ror Trailer Rear Wheel Nut
Socket (Dr.1" - 8 Point - 83 mm)**



AC108-9075

- Remove the rear wheel nut of ROR trailer to change the bearing
- The robust socket manufactured from a piece of material
- It can be used with torque wrench for installing and removing

AC

BE

BS

BK

ET

GT

OF

PS

TS

TT

UT

MS

AT

SD

ST

**Wheel Capsule And Axle Nut
Socket 65mm**



AC108-9021A

- For clean, easy loosening and tightening of flat oval wheel capsules and axle nuts, e.g. on BPW axles
- For the dismantling and assembly of grease capsule on BPW axles
- Extremely versatile
- Suitable for exact torque with a 3/4" square drive
- Ideally suited for very high tightening and loosening torques
- For machinery usage
- Special steel

**Wheel Capsule And Axle Nut
Socket 85mm**



AC108-9021C

- For clean, easy loosening and tightening of flat oval wheel capsules and axle nuts, e.g. on BPW axles
- For the dismantling and assembly of grease capsule on BPW axles
- Extremely versatile
- Suitable for exact torque with a 3/4" square drive
- Ideally suited for high tightening and loosening torques
- For machinery usage
- Special steel

**Wheel Capsule And Axle Nut
Socket 110mm**



AC108-9021E

- For clean, easy loosening and tightening of flat oval wheel capsules and axle nuts, e.g. on BPW axles
- For the dismantling and assembly of grease capsule on BPW axles
- Extremely versatile
- Suitable for exact torque with a 3/4" square drive
- Ideally suited for very high tightening and loosening torques
- For machinery usage
- Special steel

**Wheel Capsule And Axle Nut
Socket 80mm**



AC108-9021B

- For clean, easy loosening and tightening of flat oval wheel capsules and axle nuts, e.g. on BPW axles
- For the dismantling and assembly of grease capsule on BPW axles
- Extremely versatile
- Suitable for exact torque with a 3/4" square drive
- Ideally suited for very high tightening and loosening torques
- For machinery usage
- Special steel

**Wheel Capsule And Axle Nut
Socket 95mm**



AC108-9021D

- For clean, easy loosening and tightening of flat oval wheel capsules and axle nuts, e.g. on BPW axles
- For the dismantling and assembly of grease capsule on BPW axles
- Extremely versatile
- Suitable for exact torque with a 3/4" square drive
- Ideally suited for very high tightening and loosening torques
- For machinery usage
- Special steel

**Wheel Capsule And Axle Nut
Socket 120mm**



AC108-9021F

- For clean, easy loosening and tightening of flat oval wheel capsules and axle nuts, e.g. on BPW axles
- For the dismantling and assembly of grease capsule on BPW axles
- Extremely versatile
- Suitable for exact torque with a 3/4" square drive
- Ideally suited for very high tightening and loosening torques
- For machinery usage
- Special steel

**VOLVO Wheel Shaft Cover Socket
(3/4"DR. 8 point 115mm)**



AC108-9029A

- For dismantling the front / rear wheel axle cover of VOLVO
- Size: 3/4"DR. (115mm) 8 point opening
- Oval shaped

**VOLVO Wheel Shaft Cover Socket
(1"DR. 8 point 115mm)**



AC108-9029A-A

- For dismantling the front / rear wheel axle cover of VOLVO
- Size: 1"DR. (115mm) 8 point opening
- Oval shaped

**VOLVO Rear Wheel Shock Absorber
Spring Washer Removal Socket**



AC108-9029C

- 3/4"DR.
- Suitable for exact torque
- Socket profile flat oval
- Extremely versatile
- For machinery usage

VOLVO King Pin Upper Cover Socket
(3/4"DR. 6 points 80mm)



AC108-9029B

- 6 point socket profile
- Slim design
- Robust execution
- Positive drive of the axle nut
- Any extensive slipping is avoided
- Milled out profile
- Can be used with an impact wrench or torque wrench

VOLVO Truck Front / Rear Brake Shoe Lining Inside Caliper



AC108-9029E

- For the restoration of the drum brake
- For opening and fixing the brake shoes retaining spring
- For the dismantling and assembly of the jaw pins
- With drive spindle for continuous opening
- Robust execution

VOLVO Truck Axle Nut Socket
(1"DR. 6 point 95mm)



AC108-9029I

- Fix bearing while removing or installing the truck nut
- Control the nut with air wrench or rod to tighten or loosen bearing

VOLVO Truck Shock Absorber Upper Base Nut Extractor / Installer



AC108-9029D

- For the removal and installation of HGV cab shock absorbers
- For counter holding the piston rod and simultaneous turning of the screw cap
- Durable design
- For manual operation

VOLVO Front Wheel Shock Absorber Spring Washer Removal Socket (H27)



AC108-9029G

- With 6 point drive SW 27
- Suitable for exact torque
- With 2 external studs \varnothing 8.7mm
- Extremely versatile
- For machinery usage
- Special steel

Volvo Truck Fan Bearing Base Socket



AC108-9029J

- With 3/4" square drive
- Special profile with 4 internal studs
- This nut on VOLVO trucks

Engine Crank Alignment VOLVO



AC108-9029F

- Allows the engine crank to be manually adjusted
- Allows pinpoint accuracy calibration
- Ideal for adjustments to the engine
- Adjusting screw in the clutch housing

VOLVO Truck Axle Nut Socket
(1"DR. 6 point 105mm)



AC108-9029H

- Fix bearing while removing or installing the truck nut
- Use the air wrench of rod to control the nut to tighten or loosen bearing

Engine Crank Alignment DAF



AC108-9051B

- With 6 point drive SW 24
- Allows the engine crank to be manually adjusted
- Allows pinpoint accuracy calibration

AC

BE

BS

BK

ET

GT

OF

PS

TS

TT

UT

MS

AT

SD

ST

HINO Oil Mist Separator Wrench
107mm



AC108-9037A

- HINO oil mist separator wrench (8 Ribs 107mm)
- Using the oil-water separator wrench
- Looped handle
- Japanese truck repair tool
- Specialty tools

1/2"DR. Steering Mechanism Oil Seal Socket (HINO Truck)



AC108-9037D

- To loosen / tighten the nut, when replaces steering mechanism oil seal.
- It could be caused damage without using this tool while replacing oil seal
- PCD 60mm x 1/4" x 2 point

3/4"DR. HINO 11.9 Tons Rear Wheel Axle Nut Socket (105mm 8 point)



AC108-9037E

- Apply to HINO 11.9 tons truck rear wheel axle nut removal / installation

FUSO Oil Mist Separator Wrench
109mm



AC108-9039A

- Fuso oil mist separator wrench
- Using the oil-water separator wrench
- Looped handle
- Japanese truck repair tool
- Specialty tools

3/4"DR. Steering Mechanism Oil Seal Socket



AC108-9039B

- While replaces steering mechanism oil seal, to regulate the nut with this tool and prevent nut from damage
- PCD 70mm x ø6 x 4 point

Engine Crank Alignment DAF



AC108-9051C

- With 1/2" square drive
- Allows the engine crank to be manually adjusted
- Allows pinpoint accuracy calibration
- Ideal for adjustments to the engine

NISSAN Diesel Ud Truck Crankshaft Rear Oil Seal Installer



AC108-9077A

- To prevent the crankshaft rear oil seal from damage when installing it
- It is very easy to damage oil seal without using this tools

DAF XLR (euro4) Propeller Shaft Center Bearing Nut Socket



AC108-9051D

- With 3/4" square drive
- The robust socket is manufactured from a piece of material
- To remove and install the nut of propeller shaft center bearing when bearing is broken

Crankshaft Oil Seal Replacer



AC108-9053A

- The best tool for replacing crankshaft oil seal
- No damage to oil seal and related parts
- Easy to use. Help to install the oil seals accurately. Save time and money

Crankshaft Rear Oil Seal Installer (HINO J08C)



AC108-9037B

-This tool is specially designed for preventing oil seal from damaged when installing it

Crankshaft Rear Oil Seal Installer (ISUZU 3.5 Tons)



AC108-9053F

-This tool is specially designed for preventing the oil seal from damaged when installing it

NISSAN Diesel UD 350, UD 380 Truck Crankshaft Rear Oil Seal Installer



AC108-9077B

To prevent the crankshaft rear oil seal from damage when installing it

Crankshaft Front Oil Seal Installer (ISUZU 3.5 Tons)



AC108-9053G

-This tool is specially designed for preventing the oil seal from damaged when installing it

Crankshaft Front Oil Seal Installer (HINO Truck)



AC108-9037C

-This tool is designed for preventing the HINO crankshaft front oil seal from damage when installing it

3/4"DR. Steering Linkage Fixing Base Socket



AC108-9051A

-With 3/4" square drive
-Special profile with 4 internal studs
-This nut on DAF trucks

VOLVO (MP8 / MP10) Flywheel Turning Tool



AC108-9029K

-Remove plugs flywheel cover and place the rotation tool

Universal Wheel HUB Extractor



AC108-9023

-Universal wheel HUB extractor
-Variable for bolt diameter up to 300mm
-Universal for bolts up to max $\varnothing 22$ mm

Truck Injectors Solution



AC108-9027

-Injector puller solution SSANGYONG & MERCEDES
-Special injector puller solution for new generation trucks

Extended Bar Hgv Wheel Nut Wrench - American Type



AC108-9057A

-A $\varnothing 25.4$ mm with 21 x 41 x 400 mmL
-B $\varnothing 25.4$ mm with 21 x 38 x 400 mmL
-C $\varnothing 25.4$ mm with 26 x 33 x 400 mmL
-D $\varnothing 25.4$ mm x 600mmL
-E $\varnothing 25.4$ mm with 17 x 32 x 400 mmL
-F $\varnothing 25.4$ mm with 17 x 35 x 400 mmL
-G $\varnothing 25.4$ mm with 17 x 33 x 400 mmL
-H $\varnothing 25.4$ mm with 19 x 41 x 400 mmL
-I $\varnothing 25.4$ mm with 20 x 38 x 400 mmL

Truck Valve Remover / Installer



AC108-9035

-To remove and install the valve of truck
-Japan truck repair tool
-Special steel

AC

BE

BS

BK

ET

GT

OF

PS

TS

TT

UT

MS

AT

SD

ST

Calliper Adjuster Socket



AC108-9041

- Size: H24, 5teeth, 46mmL
- Barreled round shape

1" Drive Impact Extension Bar



AC108-9055

- With 1" square drive
- Special Size to L / 1M
- Chrome molybdenum

Truck Transmission Bearing Puller



AC108-9025A

- The best tools for removing truck transmission bearing
- No damage the bearing and related parts
- Easy to use. Save time and money

Universal Extractor (For Trucks Only)



AC108-9031

- For trucks axle removal
- Use this axle with spanner spin the screw
- For all Japanese truck dismantling front and rear axles
- Extremely robust execution
- Japanese truck repair tool
- Special steel

Truck Mount / Demount Tool



AC108-9055A/B

- CR-V tyre lever with hook ends
- Suitable for use on commercial vehicle tyres

Universal Wheel HUB Extractor



AC108-9023B

- Clearance between puller bolts from 110mm P.C.D to 448mm P.C.D
- Master wheel hub extractor for Japanese trucks (FUSO, HINO) and European trucks such as SCANIA & SAUER & BPW...

Truck Injection Nozzle Socket



AC108-9033

- The tool removes and installs diesel injected nozzle
- The bottom four corners
- Barreled shape
- Europe truck repair tool

Extended Bar Hgv Wheel Nut Wrench - Europe Type



AC108-9057B

- A ø7/8" with 24 x 27 x 400mmL
- B ø25.4mm with 30 x 32 x 400 mmL
- C ø25.4mm with 32 x 33 x 400 mmL
- D ø19mm 630mmL
- E ø25.4mm with 27 x 30 x 400mmL
- F ø25.4mm with 27 x 32 x 400mmL
- G ø25.4mm with 30 x 33 x 400mmL
- H ø25.4mm with 28 x 33 x 400mmL
- I ø25.4mm with 27 x 33 x 400mmL
- J ø25.4mm with 24 x 38 x 400mmL
- K ø25.4mm with 3/4" x 32 x 400mmL

Haldex Brake Linkage Adjuster Extractor



AC108-9017A

- Substantial construction for drawing off firmly sitting brake linkage adjusters
- Certain stop through ring shaped bearing area
- Special steel

**1/2" Dr. "Metric" Universal
Extension Impact Sockets, 6-Point**



AC108-9069B

Item	D2	D1	L2	L	Hex
10	25	15	9	200	10
11	25	17	9	200	11
12	25	19	11	200	12
13	25	19	11	200	13
14	25	21	11	200	14
15	25	22	11	200	15
16	25	23	11	200	16
17	25	26	13	200	17
18	25	26	13	200	18
19	25	28	13	200	19
21	25	28	13	200	21
B	25	28	13	190	1/2"

**3/4" Sq. Dr. Extra Long Impact
Socket For Wheel Nuts**



AC108-9059

Item	D2	D1	L2	L	Hex
A	44	43	40	230	13/16"
B	44	42	40	230	1-1/16"
C	44	43	40	230	1-1/8"
D	44	47	40	230	1-1/4"
E	44	54	40	230	1-1/2"
F	44	48	40	230	33
G	44	38.5	24	270	24
H	44	42	27	270	27
I	44	45	30	270	30
J	44	47	32	270	32
K	44	48	32	270	33
L	44	53.5	32	270	36
M	44	38.5	24	400	24
N	44	42	27	400	27
O	44	45	30	400	30
P	44	47	32	400	32
Q	44	48	32	400	33
R	44	53.5	32	400	36

**1" Dr. Extra Long Impact Socket
For Wheel Nuts**



AC108-9061

Item	D2	D1	L2	L	Hex
A	54	51	32	270	1-1/4"
B	54	42	24	270	24
C	54	44	26	270	26
D	54	45	27	270	27
E	54	50	30	270	30
F	54	52	32	270	32
G	54	52	32	270	33
H	54	37.5	27	400	23
I	54	38.5	30	400	24
J	54	41	32	400	26
K	54	42.5	32	400	27
L	54	45	32	400	29
M	54	46	24	400	30
N	54	48.5	27	400	32
O	54	50	30	400	33
P	54	51	32	400	34
Q	54	53.5	32	400	36
R	54	55	32	400	38

AC

BE

BS

BK

ET

GT

OF

PS

TS

TT

UT

MS

AT

SD

ST

1/2" Dr. Long Impact
Universal Bit Socket
Internal Hexagonal Screws



AC108-9071B

Item	D2	D3	L	D1
10	25	28	200	10
11	25	28	200	11
12	25	28	200	12
13	25	28	200	13
14	25	28	200	14
15	25	28	200	15
16	25	28	200	16
17	25	28	200	17
18	25	28	200	18
19	25	28	200	19
21	25	28	200	21
B	25	28	190	1/2"

1"Dr. Hexagon Torque Impact
Socket Extra Deep



AC108-9073

Item	L	size	Torque N.m
A	300	□13/16"	650
B	300	1-1/4"	340
C	300	33mm	600
D	300	1-5/16"	650
E	300	30mm	450
F	300	1-1/2"	650
G	300	24mm	350
H	300	27mm	350
I	300	27mm	450
J	300	29mm	400
K	300	30mm	350
L	300	30mm	500
M	300	30mm	550
N	300	32mm	450
O	300	32mm	500
P	300	32mm	550
Q	300	32mm	600
R	300	32mm	650
S	300	32mm	700
T	300	32mm	750
U	300	33mm	550
V	300	33mm	650
W	300	33mm	700
X	300	33mm	750
Y	300	36mm	600

3/4" Dr. Hexagon Torque Impact
Socket Extra Deep

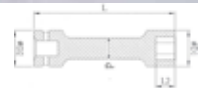

AC108-9075

Item	D2	D1	L2	L	Hex
A	42	30	23	305	□13/16"
B	42	30	18	305	1-1/4"
C	42	30	23	305	1-5/16"
D	42	30	22	305	1-1/2"

-A 650 N.m

-B 340 N.m

-C 650 N.m

-D 650 N.m



Professional
A-max[®]

A-MAX International Co., Ltd.
www.amaxtool.com.tw



Professionalism

18-plus years in making tools and hardware

Service

Most efficient and satisfactory

Quality

Strictly maintained and assured

Delivery

On-time and reliable

Price

The most competitive

R&D

Consistent and innovative

A-max[®] International Co., Ltd.

 amax@amaxtool.com

 www.amaxtool.com



A-Max International Company

A 7F.-10, No.666, Sec. 2, Wuquan W. Rd.,
Nantun Dist., Taichung City 408, Taiwan

T 886-4-2383 0286

F 886-4-2383 0287

E amax@amaxtools.com

W www.amaxtool.com